

Napier

SIGNATURE HOMES

CUSTOM DESIGNER/BUILDER

Founders Bridge Lot 11, Section 2
.674 acre in Chesterfield County
Current lot is available by calling (804) 403-3101

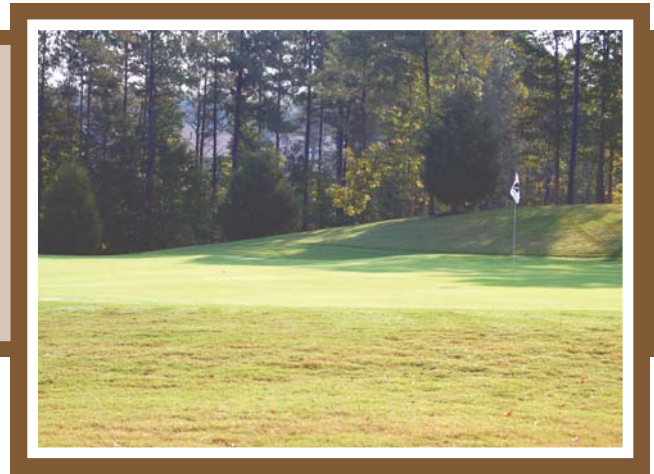

It's one of the last buildable golf course lots on the market at the championship Independence golf course in Founders Bridge in Chesterfield County.

This partially wooded lot with a slight slope overlooks the green of the 14th hole.

The award-winning community is located off historic route 711 and minutes from Route 288.

This lot has utility connections including sewer, water, gas and underground electric service.

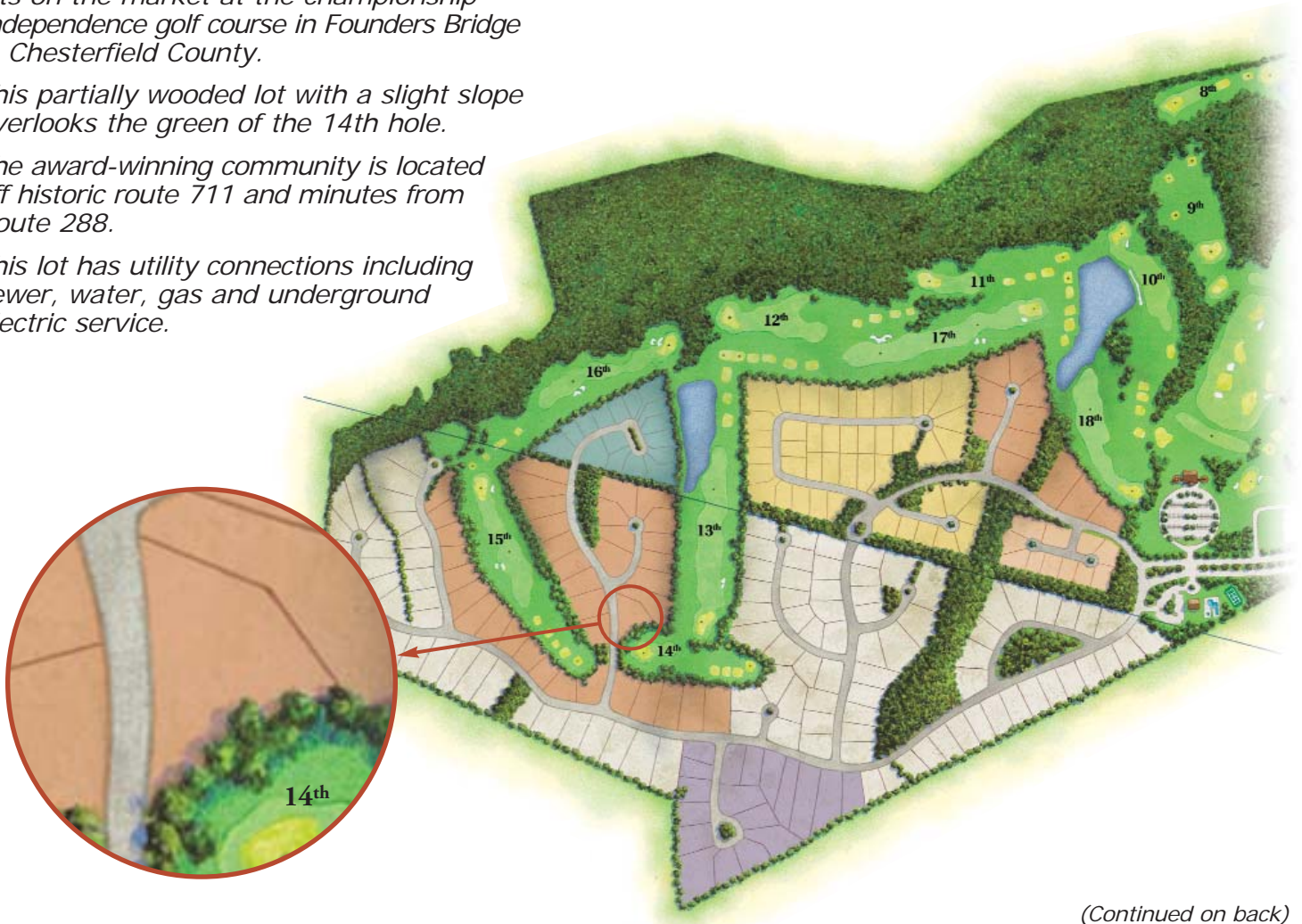

(Continued on back)

BUILDER CONTACT:

Rich Napier of Napier Signature Homes
(804) 403-3101 (office) -or- (804) 218-7741 (cell)

AGENT CONTACT:

John Farrell of GrayCo Realty LLC
(804) 379-6183

What can we build for you?



View hundreds of photos and access virtual tours of our custom homes at www.napiersignaturehomes.com

All information shown herein is deemed reliable, but is not guaranteed

► DIRECTIONS

From 288:

- From Route 288, take Huguenot Trail Exit to Route 711 East. Travel approximately 1 mile on Route 711/Huguenot Trail.
- Turn right onto Winterfield Road at the stoplight.
- Travel 0.4 miles and turn right onto Founders Bridge Boulevard.
- Take a left at the stop sign near the clubhouse.
- Follow Founders Bridge Boulevard to Maple Hall Drive.
- Turn right on Maple Hall Drive and then veer to your right on Maple Hall Court.
- The lot will be on your right.

From the intersection of Robious and Huguenot Roads:

- Travel west on Robious Road/Route 711.
- Travel approximately 4.5 miles on Robious Road (Robious Road becomes Huguenot Trail).
- Turn left onto Winterfield Road at the stoplight.
- Travel 0.4 miles and turn right onto Founders Bridge Boulevard.
- Take a left at the stop sign near the clubhouse.
- Follow Founders Bridge Boulevard to Maple Hall Drive.
- Turn right on Maple Hall Drive and then veer to your right on Maple Hall Court.
- The lot will be on your right.

► SCHOOLS

- Bettie Weaver Elementary School
- Robious Middle School
- James River High School

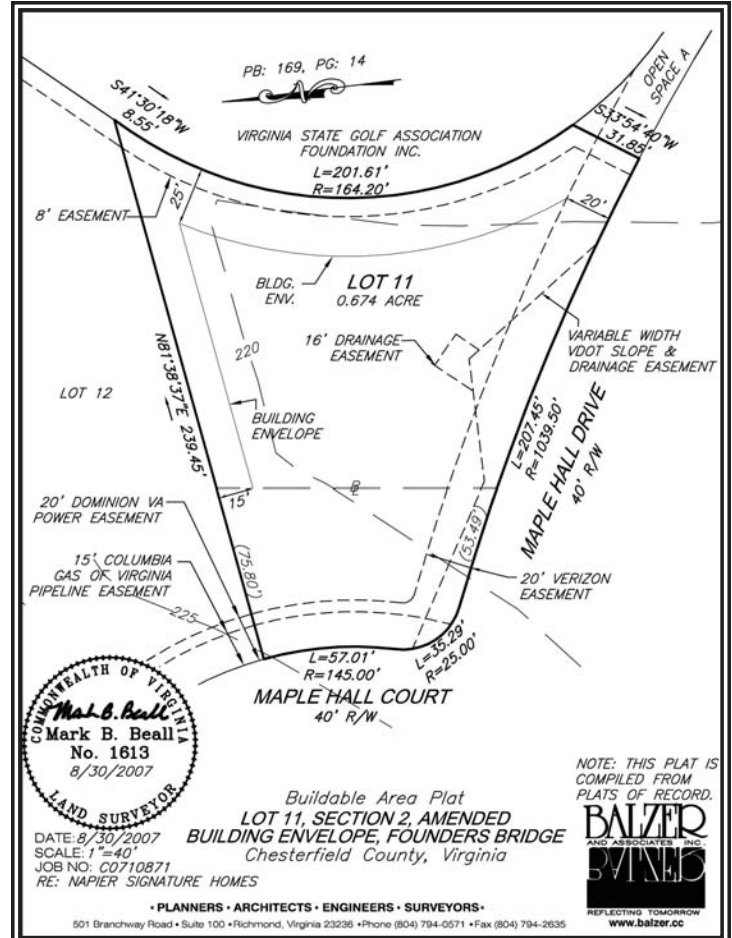

At Napier Signature Homes, we truly are custom.

We understand your dreams, designs and desires for your new home. Our homes are unique works of art — a blend of stunning designs, exceptional craftsmanship and unique features.

Our company's small size and client focus means if you can dream it, Napier Signature Homes can build it.

BUILDER CONTACT:

Rich Napier of Napier Signature Homes
(804) 403-3101 (office) -or- (804) 218-7741 (cell)

AGENT CONTACT:

John Farrell of GrayCo Realty LLC
(804) 379-6183

What can we build for you?

